

© Bechtel Corporation 2009. All rights reserved. Bechtel, Confidential, Contains information that is confidential and proprietary to Bechtel and may not be used, reproduced, or disseminated without the prior written consent of Bechtel. This drawing is the property of Bechtel and is not to be relied upon by others or used in connection with any other project.

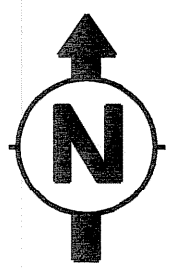
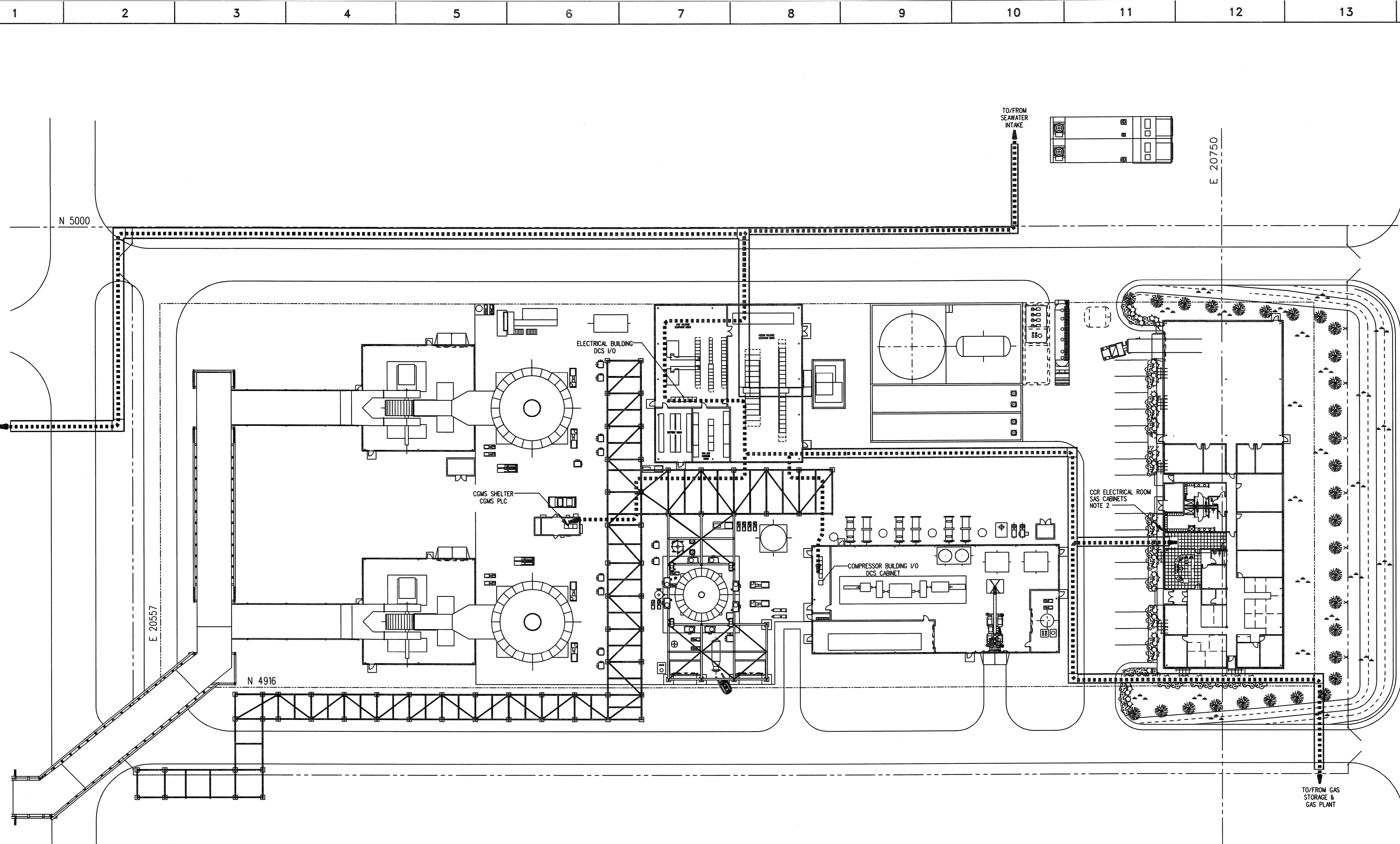

- NOTES:**
1. DCS CABLE ROUTING IS AN INDICATIVE SCHEMATIC REPRESENTATION OF SAS ARCHITECTURE DRAWING 25474-000-10-00001.
  2. CABLING WITHIN CENTRAL CONTROL ROOM AND ASSOCIATED EQUIPMENT ROOM WILL BE ROUTED UNDER COMPUTER FLOOR IN CABLE LADDER.
  3. REDUNDANT DCS CABLES WILL BE PHYSICALLY SEPARATED.

**LEGEND:**

..... FIBER OPTIC DATA HIGHWAY OR COMMUNICATIONS CABLE

PRELIMINARY

ISSUED FOR INFORMATION			
No. DATE 10112936-PB-1-TDO-0003	REVISIONS 1	BY J.S.	CHECKED J.S.
<b>GASSNOVA</b> Owner Drawing No.		<b>CO2 KARSTO PROJECT</b> Drawing No.	
10112936-PB-1-TDO-0003		CONTROL SYSTEM DATA HIGHWAY ROUTING SCHEME	
<b>BECHTEL POWER CORPORATION</b> PREPARATION, INSTALLATION		Sheet Size 594x841 "A1"	Scale SCALE
JOB NO. 25474-000	DRAWING NO. EL-0310-00001	REV. 0	